

APPENDIX A

PROPOSED SITE PLANS



P:\LONDON PROJECTS\2019\1947_PROJECT OSPREV\01 CAD\02 SHEET LAYOUT\1947-EXA-ZZ-DR-L-00100.DWG



LEGEND

HARD LANDSCAPE

- SURFACE TYPE 01 - TARMAC ROAD
- SURFACE TYPE 02 - CONCRETE BLOCK PAVING
To all primary footpaths along internal roads and when Treacast connection
- SURFACE TYPE 03 - PERMEABLE BLOCK PAVING
To all main external pedestrian routes and footways
- SURFACE TYPE 04 - PERMEABLE BLOCK PAVING
To differentiate shared surface road adjacent to park and reduce noise near workers garden
- SURFACE TYPE 05 - PERMEABLE BLOCK PAVING
To carparking and loading bays
- SURFACE TYPE 06 - PERMEABLE RESIN BOUND GRAVEL
To hardstanding areas within park, play spaces and secondary paths, and courtyards
- SURFACE TYPE 07 - CONCRETE SETTS
To memory garden, cycle parking areas and smaller static spaces
- SURFACE TYPE 08 - PERMEABLE PLAY SURFACING
Rubber bark mulch or wet pour to play areas
- SURFACE TYPE 09 - SELF-BINDING GRAVEL
To Treacast play area
- SURFACE TYPE 10 - COMPOSITE TIMBER DECKING
To eco-garden, spillout space near Plane Tree Gate, and within residential amenity areas
- SURFACE TYPE 11 - RESIDENTIAL PAVING
To private residential terraces

SOFT LANDSCAPE

- SPECIES RICH LAWN
- IN-GROUND PERENNIAL PLANTING
- PREPARED SELF-GROW BEDS
- FILTRATION GARDEN / RAINGARDEN
- EXISTING TREE TO BE RETAINED
- PROPOSED TREE OR SHRUB
- INDICATIVE SMOOTH MOUNDING IN PLAY SPACES

WALLS, EDGES, STEPS AND FURNITURE

- BRICK WALLS AND STEPS TO MATCH ADJACENT SURFACE TREATMENT ALL STEPS TO INCLUDE HANDRAILS AND TACTILES
- RESIDENTIAL STEPS AND BRICK WALLS WITH GATE TO MATCH ADJACENT SURFACE TREATMENT ALL STEPS TO INCLUDE HANDRAILS, GATES TO BE 1100mm IN HEIGHT, GATE METALWORK TO MATCH
- ECOLOGICAL CRIB WALL BOUNDARY TO RATIONALISE LEVEL CHANGE
- WAY-FINDING SIGNAGE
- SHEFFIELD CYCLE STANDS ARRANGED IN GROUPS
- DROP-DOWN BOLLARDS TO MANAGE VEHICLE MOVEMENT

SEATING AND SEAT ELEMENTS

- BUILT-TIMBER SEATING ELEMENTS AN ARRAY OF TYPOLOGIES AND FORMS ACROSS THE SCHEME WITH BACKRESTS AND ARMRESTS
- SEATING ELEMENTS AN ARRAY OF TYPOLOGIES COMPRISING COMMUNITY TABLES, LOUNGERS AND LOUNGE SETS, MEETING TABLES AND RECLINERS

SENSORY / EXTRA-CARE GARDEN

- TIMBER CIRCLE SEATS WITH BACKS AND ARMRESTS RESTS WITH CENTRAL SCULPTURAL BIRD BATH

WOMENS GARDEN + PUBLIC PARK MEMORIAL GARDEN

- STAINLESS STEEL AND TIMBER PERGOLA WITH CLIMBING SPECIES

PLAY EQUIPMENT

PLAY EQUIPMENT AND LAYOUTS OF PLAY AREAS ARE UNDER REVIEW AND ARE SUBJECT TO CHANGE. THE LIST BELOW IS INDICATIVE AND NON-EXHAUSTIVE.

P01	ROBINIA STILTS SUPPLIER: KOMPAN	P20	RESIDENTIAL HAMMOCKS SUPPLIER: TO BE CONFIRMED
P02	ROBINIA BALANCE BEAM ON SPRINGS SUPPLIER: RICHTER SPIELGERÄTE	P21	OUTDOOR MARBLES TABLE SUPPLIER: RICHTER SPIELGERÄTE
P03	CUBE SEATS SUPPLIER: WOODSCAPE	P22	JUMPING DISCS SUPPLIER: RICHTER SPIELGERÄTE
P04	ROBINIA BALANCE POSTS WITH ROPE SUPPLIER: KOMPAN	P23	YOU AND ME SWING SUPPLIER: KOMPAN
P05	ROBINIA BALANCE PLUS SUPPLIER: KOMPAN	P24	TIMBER ANIMALS SUPPLIER: RICHTER SPIELGERÄTE
P06	TROLLS BALANCE BEAM SUPPLIER: LAPPSET	P25	DUAL SWING SET SUPPLIER: KOMPAN
P07	STEPPING LOSS - CLOVER SUPPLIER: LAPPSET	P26	SUPERNOVA SUPPLIER: KOMPAN
P08	EPDM BALLS - VARIOUS SIZES SUPPLIER: STILAM	P27	CUSTOM PLAY TOWER WITH SLIDES, SWING BRIDGES, CLIMBING NETS, HIGH ROPES COURSE, HAND GRIPS AND CLIMBABLE MESH, FIREMAN'S POLE AND FEATURE SLIDES SUPPLIER: TO BE CONFIRMED
P09	SMALL SEE-SAW SPRINGER SUPPLIER: RICHTER SPIELGERÄTE	P28	SPINNER BOWL SUPPLIER: KOMPAN
P10	TALK TUBES SUPPLIER: JUPITER PLAY	P29	FOSSIL ROCKS AND CLIMBERS SUPPLIER: TO BE CONFIRMED
P11	SLIDE TO MOUNDED PLAY AREA SUPPLIER: RICHTER SPIELGERÄTE	P30	BUG HOTELS AND MAGNIFYING STATIONS SUPPLIER: TO BE CONFIRMED
P12	WOBBLE DISC SUPPLIER: RICHTER SPIELGERÄTE	P31	TIMBER BALANCING AND CLIMBING ELEMENTS TO CREATE NATURE TRAIL UNDER EXISTING TREES AND IN NATURE GARDEN SUPPLIER: KOMPAN
P13	BIRDS NEST SWING SUPPLIER: KOMPAN	P32	COMPONENT PRODUCTS: AGILITY TRAIL 5 AGILITY TRAIL 8 BALANCE COMBINATION SITTING POLES (STEPPING LOGS) SUPPLIER: KOMPAN
P14	TEE-PEE AND TODDLER TABLE SUPPLIER: DUNCAN AND GROVE	P33	MID-KITCHEN AND LEARNING AREA SUPPLIER: TO BE CONFIRMED
P15	CLIMBING HOLDS AND ROPE SUPPLIER: CORE CLIMBING	P34	OUTDOOR TABLE TENNIS TABLES SUPPLIER: TO BE CONFIRMED
P16	SCRAMBLING CUBE BLOCKS SUPPLIER: WOODSCAPE	P35	SPINNER SUPPLIER: KOMPAN
P17	HERONS NEST SUPPLIER: HANDMADE PLACES		
P18	MEMORY GAME SUPPLIER: RICHTER SPIELGERÄTE		
P19	WIDOWS WEB NEST SUPPLIER: SOVEREIGN PLAY		

ECOLOGICAL ENHANCEMENT AND HABITAT

ANIMAL HOMES AND FINAL QUANTITIES TO BE SELECTED BY QUALIFIED PROJECT ECOLOGIST. ALL ANIMAL HOMES TO BE LOCATED FACING SOUTH OR WEST. PROPOSED HOMES INTEGRATED WITHIN THE FRAMEWORK OF THE BUILDING FACADE ARE NOT SHOWN.

- EC01 STARKING BOXES
min. 2 or 3m above ground, and placed in groups to accommodate starting colonies
- EC02 BUG HOTEL
To be filled with organic material from removed trees

No dimensions are to be scaled from this drawing. All dimensions are to be checked on site. Area measurements for indicative purposes only.

This drawing is the property of Exterior Architecture Ltd. No part of the drawing may be reproduced in any manner without permission from Exterior Architecture Ltd.

Client
PEABODY

P01	PLANNING SUBMISSION	01.11.2021
Rev	Description	Date

EXTERIOR ARCHITECTURE

LONDON
Unit 17.1, The Leather Market, 11-13 Weston Street, London, SE1 3ER

MANCHESTER
Studio 537, The Royal Exchange, St Anns Square, Manchester, M2 7DH

E-MAIL office@exteriorarchitecture.com
WEB www.exteriorarchitecture.com

Project title
PROJECT HOLLOWAY

Drawing title
**Landscape General Arrangement
Plan_Ground Floor**

Issued By London
Scale 1:500 @ A1
Status PLANNING
Date 01.11.2021

T: 020 7978 2101
Drawn EXA
Checked TOD
Approved LP

Drawing number
1947-EXA-ZZ-DR-L-00100

Revision
P01

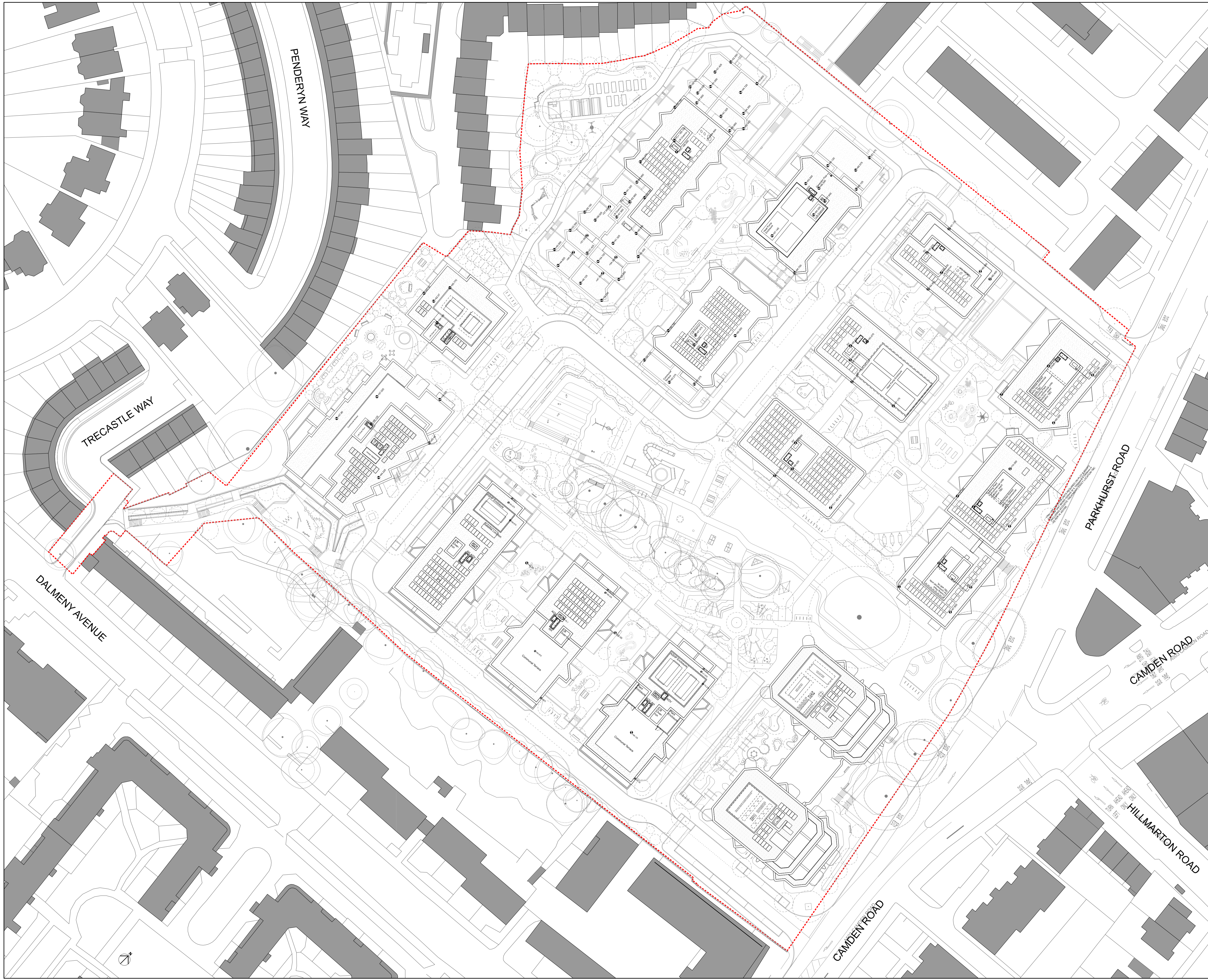

KEY

1 BED	CYCLE STORE
2 BED	EXTRA-CARE
3 BED	RESIDENTS SHARED FACILITIES
4 BED	SOCIAL RENT
WOMENS BUILDING	LONDON SHARED OWNERSHIP
REFUSE STORE	PRIVATE
COMMERCIAL	SHARED BETWEEN PRIVATE AND LSO
PLANT	AH ACCESS HATCH
BIODIVERSE ROOF	SV SMOKE VENT
	PV PHOTOVOLTAIC PANELS
	AOV AUTOMATIC OPENING VENTS
	DRY RISER INLET

0 1m 2m 5m 10m

LANDSCAPE AND PUBLIC REALM INDICATIVE. REFER TO LANDSCAPE ARCHITECT INFORMATION.

29/05/20 INFORMATION

REV	DATE	INFORMATION
		29/05/20 INFORMATION

NOTE

When this drawing is issued in uncontrolled CAD format it will be accompanied by a PDF version and is issued to enable the recipient to prepare their own documents / models / drawings for which they are solely responsible. The recipient should report all drawing errors, omissions and discrepancies to the architect. All dimensions should be checked on site by the contractor and such dimensions shall be the contractor's responsibility.

Allford Hall Monaghan Morris Limited accepts no responsibility or liability for:-
 - any use of this drawing by parties other than the party for whom it was prepared or for purposes other than those for which it was prepared
 - any alterations or additions to or discrepancies arising out of changes to the background information on which the drawings are based that was current at the time of issue, and which occur to that information after it has been issued by AHMM
 - any loss or degradation of the information held in this drawing resulting from the translation from the original file format to any other file format or from the recipient's reading of it in any other programme or any version of the programme other than that which was used to prepare it
 - the accuracy of survey information provided by others or for any costs, claims, proceedings and expenses arising out of reliance on such information
 - any scaling from this drawing other than by the local planning authority solely for the purposes of the planning application to which it relates

LOCATION

ALLFORD HALL MONAGHAN MORRIS
 ARCHITECTS Ltd
 MORELANDS, 5-23 OLD STREET LONDON EC1V 9HL
 TEL 020 7251 5261 FAX 020 7251 5123 WEB WWW.AHMM.CO.UK

PROJECT HOLLOWAY			
drawing title / location			
MASTERPLAN PROPOSED SITE PLAN			
drawn by	checked	scale	status
AC	LL	1:500@A1; 1:1000@A3	INFORMATION
project	zone	source	classification
17105	0	-	(00)_100 -

